

LIFE SAFTY PLAN

SCALE : 1/8" = 1'-0"

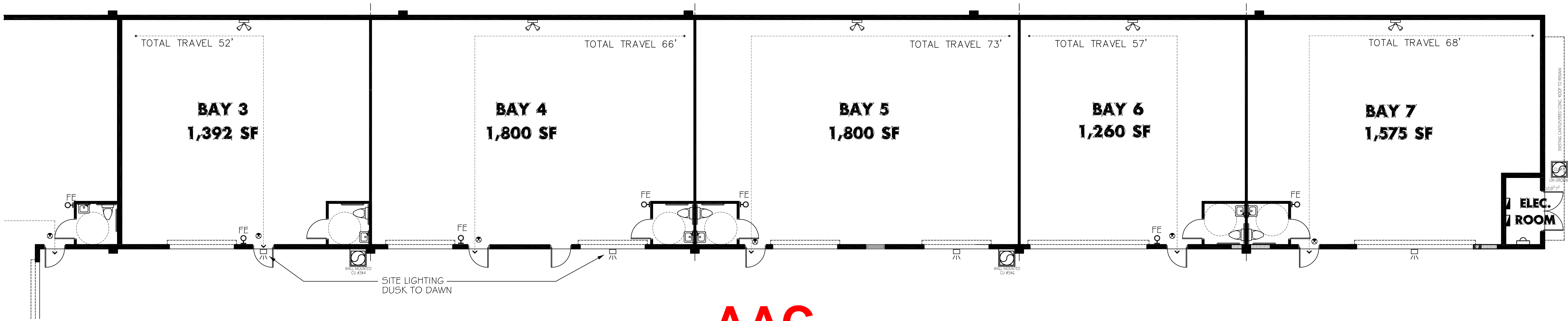

LIFE SAFTY PLAN

SCALE : 1/8" = 1'-0"

AAC

PZ25-12000014

08/20/2025

BUILDING CODE ANALYSIS

OCCUPANCY:
EXISTING OCCUPANCY: F1
TYPE 3 CONSTRUCTION, UN-PROTECTED, FIRE SPRINKLED
MAX SF = 36,000

SEPARATION OF OCCUPANCIES
TABLE 508.4 – F1 TO F1 = NO SEPARATION REQUIREMENT

MEANS OF EGRESS:
MAXIMUM PATH OF COMMON TRAVEL: 100'
MINIMUM CORRIDOR/AISLE WIDTH: 44 INCHES
MINIMUM CLEAR OPENING OF EXIT DOORS:
.20 INCHES PER OCCUPANT

OCCUPANCY LOAD:
WAREHOUSE= 500 GROSS 12,788 S.F./500 = 26 OCCUPANTS
26 TOTAL OCCUPANTS AS DESIGNED

LIFE SAFETY LEGEND

DUAL HEAD EMERGENCY LIGHT W/
BATTERY PACK & BULB

EXIT SIGN W/ DIRECTIONAL INDICATORS
& BATTERY PACK

DENOTES COMMON TRAVEL DISTANCE OR
ACCESS TO A PUBLIC WAY W/ MIN. CLEAR
WIDTH OF 44"

DENOTES OVERALL TRAVEL DISTANCE OR
ACCESS TO A PUBLIC WAY W/ MIN. CLEAR
WIDTH OF 44"

(ONLY WORST CASE SCENARIO IS REPRESENTED)
DESIGNATES EGRESS PATH

OF TRAVEL PATH
DENOTES EXIT DOOR DESTINATION @ END

DENOTES NEW FIRE EXTINGUISHER (K-TYPE)
ON HOOK SPACED AT INTERVALS
OF 75' MAXIMUM TRAVEL (VERIFY LOC.)

EXIT SIGNS

ARROW POINT OF SHADED PORTION OF CLG. MOUNT EXIT
LIGHT/EMERG. COMBO POINTS IN THE INTENDED DIRECTION OF TRAVEL
TO THE NEAREST EXIT DISCHARGING TO EXTERIOR OF BUILDING (TYPICAL)

EXIT

EXIT

EXIT

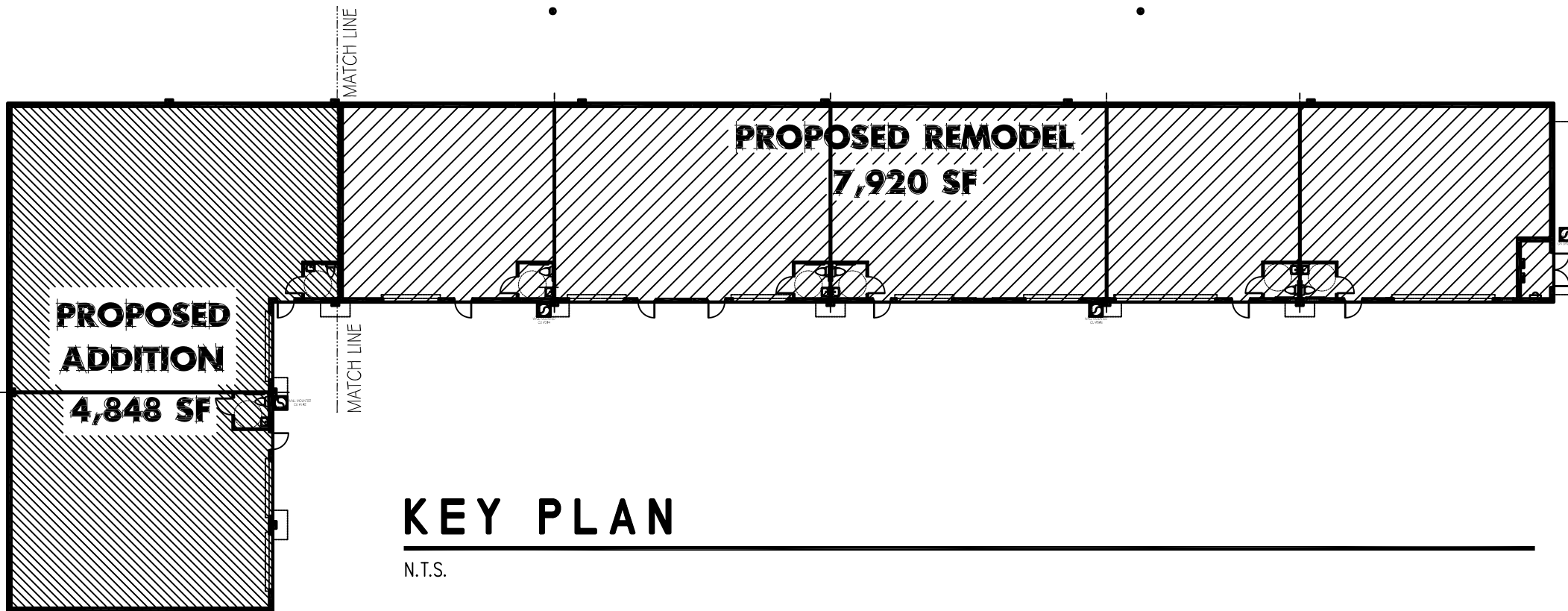

YATES ASSOCIATES
ARCHITECTURE INC.

ARCHITECTURE •
PLANNING •
INTERIOR DESIGN •

AA-26001673
330 CLEMATIS ST., SUITE 210
WEST PALM BEACH, FL 33401
TEL: 561-653-8280 FAX: 561-653-8279
WWW.YATESARCHITECTURE.COM
EMAIL: KELLY@YATESARCHITECTURE.COM

DATE: 12-16-24
JOB NO: 24-1289
DESIGN BY: JCH
DRAWN BY: JCH
APPROVED: KDY
REVISIONS:

COMMERCIAL TENANT IMPROVEMENT PLANS:

LT 20 LLC
115 NW 16TH ST.
POMPANO BEACH FL 33060

AAC
REVIEW
09-22-25

KELLY D. YATES
FLORIDA AR 13706

SHEET NO.

A-1

OF - SHTS

Copyright © 2025 Yates Architecture Inc.

This package is copyrighted. All rights reserved. No part of this package may be reproduced or distributed in any form or by any means, including the making of copies by any photo process or by any electronic or mechanical device, printed, written, drawn, or oral, or the storing, in a data base or retrieval system, without the prior written permission, from the designer.